

# 2011 Campus Safety and Security Survey

Institution: Seminole State College (207740) -  
Seminole State College (001)

User ID: C12077401

## Screening Questions

Please answer these questions carefully. The answers you provide will determine which screens you will be asked to complete for this data collection.

### 1. Does your institution provide On-Campus Student Housing Facilities?

- No.
- Yes. (If Yes is selected, you must enter the number of student housing facilities below and enter Fire Statistics for each facility.)

	Last Year
Number of On-campus Student Housing Facilities:	<input type="text" value="2"/> 2

### 2. Does your institution have any noncampus buildings or properties?

- Yes  No

### 3. Have you combined statistics that you received from the local or state police with your institution statistics for this report? If you answer No to this question, you will be asked to provide the data you received from the local and state police separately.

- Yes. Local and/or state law enforcement agencies provided us with statistics that we are combining with statistics collected by our campus security authorities.
- No. We are not combining the statistics because we cannot determine whether the statistics we obtained from local and/or state law enforcement agencies are for on-campus incidents or public property incidents.
- Not available. We cannot determine if the statistics we obtained from local and/or state law enforcement agencies are for our Clery geography.

**Not available.** We made a good-faith effort to obtain statistics from local and/or state law enforcement agencies, but the agencies did not comply with our request.

Institution: Seminole State College (207740) -  
Seminole State College (001)

User ID: C12077401

## Criminal Offenses - On campus

**For each of the following criminal offenses, enter the number reported to have occurred On Campus.**

Criminal offense	Total occurrences On campus		
	2008	2009	2010
a. <u>Murder/Non-negligent manslaughter</u>	0	0	0
b. <u>Negligent manslaughter</u>	0	0	0
c. <u>Sex offenses - Forcible</u>	0	1	0
d. <u>Sex offenses - Non-forcible</u>	0	0	0
Incest		0	0
Statutory rape		0	0
e. <u>Robbery</u>	0	0	0
f. <u>Aggravated assault</u>	0	0	0
g. <u>Burglary</u>	2	4	4
h. <u>Motor vehicle theft</u> (Do not include theft <i>from</i> a motor vehicle)	0	1	0
i. <u>Arson</u>	0	0	0

**Caveat:**

If you have changed prior years' data, you must add a caveat explaining the change. Use the following format: "For (YEAR). Line (X) was changed from (A) to (B) because



i. Arson

0

0

0

**Caveat:**

If you have changed prior years' data, you must add a caveat explaining the change. Use the following format: "For (YEAR), Line (X) was changed from (A) to (B) because (REASON)."



Institution: Seminole State College (207740) -  
Seminole State College (001)

User ID: C12077401

## Criminal Offenses - Noncampus

**For each of the following criminal offenses, enter the number reported to have occurred in or on Noncampus buildings or property.**

Criminal offense	Total occurrences in or on Noncampus buildings or property		
	2008	2009	2010
a. <u>Murder/Non-negligent manslaughter</u>	0	0	0
b. <u>Negligent manslaughter</u>	0	0	0
c. <u>Sex offenses - Forcible</u>	0	0	0
d. <u>Sex offenses - Non-Forcible</u>	0	0	0
Incest		0	0
Statutory rape		0	0
e. <u>Robbery</u>	0	0	0
f. <u>Aggravated assault</u>	0	0	0
g. <u>Burglary</u>	0	3	5

h. <u>Motor vehicle theft</u> (Do not include theft <i>from</i> a motor vehicle)	0	<input type="text" value="0"/>	<input type="text" value="0"/>
i. <u>Arson</u>	0	<input type="text" value="0"/>	<input type="text" value="0"/>

**Caveat:**

If you have changed prior years' data, you must add a caveat explaining the change. Use the following format: "For (YEAR), Line (X) was changed from (A) to (B) because (REASON)."

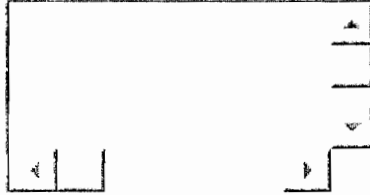

Institution: Seminole State College (207740) -  
Seminole State College (001)

User ID: C12077401

## Criminal Offenses - Public Property

**For each of the following criminal offenses, enter the number reported to have occurred on Public Property.**

Criminal offense	Total occurrences on Public Property		
	2008	2009	2010
a. <u>Murder/Non-negligent manslaughter</u>	0	<input type="text" value="0"/>	<input type="text" value="0"/>
b. <u>Negligent manslaughter</u>	0	<input type="text" value="0"/>	<input type="text" value="0"/>
c. <u>Sex offenses - Forcible</u>	0	<input type="text" value="0"/>	<input type="text" value="0"/>
d. <u>Sex offenses - Non-forcible</u>	0	0	0
Incest		<input type="text" value="0"/>	<input type="text" value="0"/>
Statutory rape		<input type="text" value="0"/>	<input type="text" value="0"/>
e. <u>Robbery</u>	0	<input type="text" value="0"/>	<input type="text" value="0"/>
f. <u>Aggravated assault</u>	0	<input type="text" value="0"/>	<input type="text" value="0"/>

g. <u>Burglary</u>	0	<input type="text" value="0"/>	<input type="text" value="0"/>
h. <u>Motor vehicle theft</u> (Do not include theft <i>from</i> a motor vehicle)	0	<input type="text" value="0"/>	<input type="text" value="0"/>
i. <u>Arson</u>	0	<input type="text" value="0"/>	<input type="text" value="0"/>

**Caveat:**

If you have changed prior years' data, you must add a caveat explaining the change. Use the following format: "For (YEAR), Line (X) was changed from (A) to (B) because (REASON)."

Institution: Seminole State College (207740) -  
Seminole State College (001)

User ID: C12077401

## Hate Crimes - On campus

**For the criminal offenses listed below, first enter the total number of Hate Crimes that were reported to have occurred On campus. Then break down each total by category of bias (e.g., race, religion).**

Occurrences of Hate crimes

Category of Bias for crimes reported in 2010

Criminal offense	2010 Total	Race	Religion	Sexual orientation	Gender	Disability	Ethnicity/ National origin
a. <u>Murder/Non-negligent manslaughter</u>	<input type="text" value="0"/>	<input type="text" value="0"/>	<input type="text" value="0"/>	<input type="text" value="0"/>	<input type="text" value="0"/>	<input type="text" value="0"/>	<input type="text" value="0"/>
b. <u>Negligent manslaughter</u>							

c. <u>Sex offenses - Forcible</u>	0	0	0	0	0	0	0
d. <u>Sex offenses - Non-forcible</u>	0	0	0	0	0	0	0
Incest	0	0	0	0	0	0	0
Statutory rape	0	0	0	0	0	0	0
e. <u>Robbery</u>	0	0	0	0	0	0	0
f. <u>Aggravated assault</u>	0	0	0	0	0	0	0
g. <u>Burglary</u>	0	0	0	0	0	0	0
h. <u>Motor vehicle theft</u> (Do not include theft from a motor vehicle)	0	0	0	0	0	0	0
i. <u>Arson</u>	0	0	0	0	0	0	0
j. <u>Simple assault</u>	0	0	0	0	0	0	0
k. <u>Larceny-theft</u>	0	0	0	0	0	0	0
l. <u>Intimidation</u>	0	0	0	0	0	0	0
m. <u>Destruction/da</u>	0	0	0	0	0	0	0



h. Motor vehicle theft  
(Do not include theft from a motor vehicle)

0 | 0 | 0 | 0 | 0 | 0 | 0 | 0

i. Arson

0 | 0 | 0 | 0 | 0 | 0 | 0 | 0

j. Simple assault

0 | 0 | 0 | 0 | 0 | 0 | 0 | 0

k. Larceny-theft

0 | 0 | 0 | 0 | 0 | 0 | 0 | 0

l. Intimidation

0 | 0 | 0 | 0 | 0 | 0 | 0 | 0

m. Destruction/damage/vandalism of property

0 | 0 | 0 | 0 | 0 | 0 | 0 | 0

**Caveat:**

If you have changed prior years' data, you must add a caveat explaining the change. Use the following format: "For (YEAR), Line (X) was changed from (A) to (B) because (REASON)."

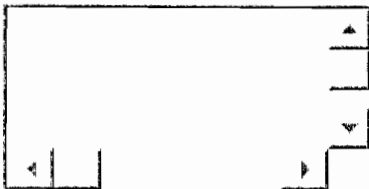

---

Institution: Seminole State College (207740) -  
Seminole State College (001)

User ID: C12077401

## Hate Crimes - On-campus Student

# Housing Facilities

**For the criminal offenses listed below, first enter the total number of Hate Crimes that were reported to have occurred in On-Campus Student Housing Facilities. Then break down each total by category of bias (e.g., race, religion).**

## Occurrences of Hate crimes

### Category of Bias for crimes reported in 2010

Criminal offense	2010 Total	Race	Religion	Sexual orientation	Gender	Disability	Ethnicity/ National origin
a. <u>Murder/ Non-negligent manslaughter</u>	0	0	0	0	0	0	0
b. <u>Negligent manslaughter</u>							
c. <u>Sex offenses - Forcible</u>	0	0	0	0	0	0	0
d. <u>Sex offenses - Non-forcible</u>	0	0	0	0	0	0	0
Incest	0	0	0	0	0	0	0
Statutory rape	0	0	0	0	0	0	0
e. <u>Robbery</u>	0	0	0	0	0	0	0
f. <u>Aggravated assault</u>	0	0	0	0	0	0	0
g. <u>Burglary</u>							



c. <u>Sex offenses - Forcible</u>	0	0	0	0	0	0	0
d. <u>Sex offenses - Non-forcible</u>	0	0	0	0	0	0	0
Incest		0	0	0	0	0	0
Statutory rape		0	0	0	0	0	0
e. <u>Robbery</u>	0	0	0	0	0	0	0
f. <u>Aggravated assault</u>	0	0	0	0	0	0	0
g. <u>Burglary</u>	0	0	0	0	0	0	0
h. <u>Motor vehicle theft</u> (Do not include theft from a motor vehicle)	0	0	0	0	0	0	0
i. <u>Arson</u>	0	0	0	0	0	0	0
j. <u>Simple assault</u>	0	0	0	0	0	0	0
k. <u>Larceny-theft</u>		0	0	0	0	0	0
l. <u>Intimidation</u>		0	0	0	0	0	0
m. <u>Destruction/da</u>		0	0	0	0	0	0

image/  
vandalism of p  
roperty

**Caveat:**

If you have changed prior years' data, you must add a caveat explaining the change. Use the following format: "For (YEAR), Line (X) was changed from (A) to (B) because (REASON)."

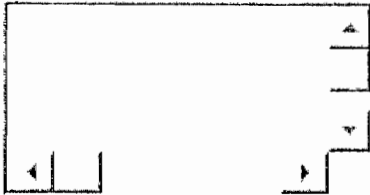

Institution: Seminole State College (207740) -  
Seminole State College (001)

User ID: C12077401

## Hate Crimes - Noncampus

**For the criminal offenses listed below, first enter the total number of Hate Crimes that were reported to have occurred in or on Noncampus buildings or property. Then break down each total by category of bias (e.g., race, religion).**

### Occurrences of Hate crimes

### Category of Bias for crimes reported in 2010

Criminal offense	2010 Total	Category of Bias for crimes reported in 2010					
		Race	Religion	Sexual orientation	Gender	Disability	Ethnicity/ National origin
a. <u>Murder/ Non-negligent manslaughter</u>	0	0	0	0	0	0	0
b. <u>Negligent manslaughter</u>							
c. <u>Sex offenses - Forcible</u>	0	0	0	0	0	0	0

d. Sex offenses - Non-forcible

0 0 0 0 0 0 0

Incest

0 0 0 0 0 0 0

Statutory rape

0 0 0 0 0 0 0

e. Robbery

0 0 0 0 0 0 0

f. Aggravated assault

0 0 0 0 0 0 0

g. Burglary

0 0 0 0 0 0 0

h. Motor vehicle theft  
(Do not include theft from a motor vehicle)

0 0 0 0 0 0 0

i. Arson

0 0 0 0 0 0 0

j. Simple assault

0 0 0 0 0 0 0

k. Larceny-theft

0 0 0 0 0 0 0

l. Intimidation

0 0 0 0 0 0 0

m. Destruction/damage/vandalism of

0 0 0 0 0 0 0

roperty

Occurrences of Hate crimes

Category of Bias for crimes reported in 2009

Criminal offense	2008 Total	2009 Total	Race	Religion	Sexual orientation	Gender	Disability	Ethnicity/National origin
a. <u>Murder/ Non-negligent manslaughter</u>	0	0	0	0	0	0	0	0
b. <u>Negligent manslaughter</u>								
c. <u>Sex offenses - Forcible</u>	0	0	0	0	0	0	0	0
d. <u>Sex offenses - Non-forcible</u>	0	0	0	0	0	0	0	0
Incest		0	0	0	0	0	0	0
Statutory rape		0	0	0	0	0	0	0
e. <u>Robbery</u>	0	0	0	0	0	0	0	0
f. <u>Aggravated assault</u>	0	0	0	0	0	0	0	0
g. <u>Burglary</u>	0	0	0	0	0	0	0	0
h. <u>Motor vehicle theft</u>	0							

(Do not include theft from a motor vehicle)

0	0	0	0	0	0	0
---	---	---	---	---	---	---

i. Arson

0	0	0	0	0	0	0
---	---	---	---	---	---	---

j. Simple assault

0	0	0	0	0	0	0
---	---	---	---	---	---	---

k. Larceny-theft

0	0	0	0	0	0	0
---	---	---	---	---	---	---

l. Intimidation

0	0	0	0	0	0	0
---	---	---	---	---	---	---

m. Destruction/damage/vandalism of property

0	0	0	0	0	0	0
---	---	---	---	---	---	---

**Caveat:**

If you have changed prior years' data, you must add a caveat explaining the change. Use the following format: "For (YEAR), Line (X) was changed from (A) to (B) because (REASON)."

		▲
		▼
◀	▶	

Institution: Seminole State College (207740) -  
Seminole State College (001)

User ID: C12077401

## Hate Crimes - Public Property

**For the criminal offenses listed below, first enter the total number of Hate**

**Crimes that were reported to have occurred on Public Property. Then break down each total by category of bias (e.g., race, religion).**

Occurrences of Hate crimes

Category of Bias for crimes reported in 2010

Criminal offense	2010 Total	Race	Religion	Sexual orientation	Gender	Disability	Ethnicity/ National origin
a. <u>Murder/ Non-negligent manslaughter</u>	0	0	0	0	0	0	0
b. <u>Negligent manslaughter</u>							
c. <u>Sex offenses - Forcible</u>	0	0	0	0	0	0	0
d. <u>Sex offenses - Non-forcible</u>	0	0	0	0	0	0	0
Incest	0	0	0	0	0	0	0
Statutory rape	0	0	0	0	0	0	0
e. <u>Robbery</u>	0	0	0	0	0	0	0
f. <u>Aggravated assault</u>	0	0	0	0	0	0	0
g. <u>Burglary</u>	0	0	0	0	0	0	0
h. <u>Motor vehicle theft</u> (Do not include theft from a motor	0	0	0	0	0	0	0



Incest		0	0	0	0	0	0	0
Statutory rape		0	0	0	0	0	0	0
e. <u>Robbery</u>	0	0	0	0	0	0	0	0
f. <u>Aggravated assault</u>	0	0	0	0	0	0	0	0
g. <u>Burglary</u>	0	0	0	0	0	0	0	0
h. <u>Motor vehicle theft</u> (Do not include theft from a motor vehicle)	0	0	0	0	0	0	0	0
i. <u>Arson</u>	0	0	0	0	0	0	0	0
j. <u>Simple assault</u>	0	0	0	0	0	0	0	0
k. <u>Larceny-theft</u>		0	0	0	0	0	0	0
l. <u>Intimidation</u>		0	0	0	0	0	0	0
m. <u>Destruction/damage/vandalism of property</u>		0	0	0	0	0	0	0

**Caveat:**

If you have changed prior years' data, you must add a caveat explaining the change. Use the following format: "For (YEAR). Line (X) was changed from (A) to (B) because

(REASON).”

Institution: Seminole State College (207740) -  
Seminole State College (001)

User ID: C12077401

## Arrests - On campus

**Enter the number of Arrests for each of the following crimes that occurred On Campus.**

Do NOT include drunkenness or driving under the influence in Liquor law violations.

Crime	Number of Arrests		
	2008	2009	2010
a. <u>Weapons: carrying, possessing, etc.</u>	0	<input type="text" value="0"/>	<input type="text" value="0"/>
b. <u>Drug abuse violations</u>	0	<input type="text" value="0"/>	<input type="text" value="0"/>
c. <u>Liquor law violations</u>	0	<input type="text" value="0"/>	<input type="text" value="0"/>

**Caveat:**

If you have changed prior years' data, you must add a caveat explaining the change. Use the following format: "For (YEAR), Line (X) was changed from (A) to (B) because (REASON).”

## Arrests - On-campus Student Housing Facilities

**Of those Arrests for crimes that occurred On Campus, enter the number of crimes that occurred in On-campus Student Housing Facilities for each of the following categories.**

Do NOT include drunkenness or driving under the influence in Liquor law violations.

	Number of Arrests		
Crime	2008	2009	2010
a. <u>Weapons: carrying, possessing, etc.</u>	0	0	0
b. <u>Drug abuse violations</u>	0	0	0
c. <u>Liquor law violations</u>	0	0	0

**Caveat:**

If you have changed prior years' data, you must add a caveat explaining the change. Use the following format: "For (YEAR), Line (X) was changed from (A) to (B) because (REASON)."

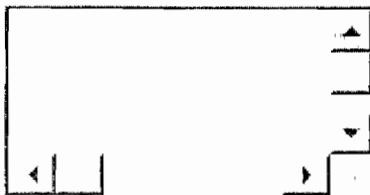

## Arrests - Noncampus

**Enter the number of Arrests for each of the following crimes that occurred in or on Noncampus buildings or property.**

Do NOT include drunkenness or driving under the influence in Liquor law violations.

Crime	Number of Arrests		
	2008	2009	2010
a. <u>Weapons: carrying, possessing, etc.</u>	0	<input type="text" value="0"/>	<input type="text" value="0"/>
b. <u>Drug abuse violations</u>	0	<input type="text" value="0"/>	<input type="text" value="0"/>
c. <u>Liquor law violations</u>	2	<input type="text" value="0"/>	<input type="text" value="0"/>

**Caveat:**

If you have changed prior years' data, you must add a caveat explaining the change. Use the following format: "For (YEAR), Line (X) was changed from (A) to (B) because (REASON)."

▲

▼

◀

▶

Institution: Seminole State College (207740) -  
Seminole State College (001)

User ID: C12077401

## Arrests - Public Property

**Enter the number of Arrests for each of the following crimes that occurred on Public Property.**

Do NOT include drunkenness or driving under the influence in Liquor law violations.

Crime	Number of Arrests		
	2008	2009	2010
a. <u>Weapons: carrying, possessing, etc.</u>	0	<input type="text" value="0"/>	<input type="text" value="0"/>

b. <u>Drug abuse violations</u>	0	<input type="text" value="0"/>	<input type="text" value="0"/>
c. <u>Liquor law violations</u>	0	<input type="text" value="0"/>	<input type="text" value="0"/>

**Caveat:**

If you have changed prior years' data, you must add a caveat explaining the change. Use the following format: "For (YEAR), Line (X) was changed from (A) to (B) because (REASON)."

Institution: Seminole State College (207740) -  
Seminole State College (001)

User ID: C12077401

## Disciplinary Actions - On Campus

**Enter the number of persons referred for disciplinary action for crimes that occurred On Campus for each of the following categories. Do not include disciplinary actions that were strictly for school policy violations. If the disciplinary action is the result of an arrest, please do not count it here; count the violation as 1 arrest.**

**Do NOT include drunkenness or driving under the influence in Liquor law violations.**

Crime	Number of persons referred for Disciplinary Action		
	2008	2009	2010
a. <u>Weapons: carrying, possessing, etc.</u>	1	<input type="text" value="0"/>	<input type="text" value="0"/>
b. <u>Drug abuse violations</u>	0	<input type="text" value="1"/>	<input type="text" value="3"/>
c. <u>Liquor law violations</u>	3	<input type="text" value="4"/>	<input type="text" value="0"/>

**Caveat:**

If you have changed prior years' data, you must add a caveat explaining the change.

Use the following format: "For (YEAR), Line (X) was changed from (A) to (B) because (REASON)."

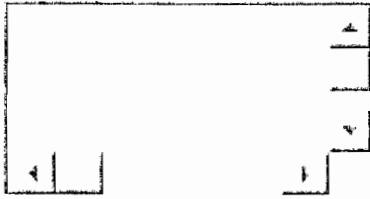

Institution: Seminole State College (207740) -  
Seminole State College (001)

User ID: C12077401

## Disciplinary Actions - On-campus Student Housing Facilities

**Enter the number of persons referred for disciplinary action for crimes that occurred in On-campus Student Housing Facilities for each of the following categories.**  
**Do not include disciplinary actions that were strictly for school policy violations.**  
**If the disciplinary action is the result of an arrest, please do not count it here; count the violation as 1 arrest.**

**Do NOT include drunkenness or driving under the influence in Liquor law violations.**

Crime	Number of persons referred for Disciplinary Action		
	2008	2009	2010
a. <u>Weapons: carrying, possessing, etc.</u>	1	0	0
b. <u>Drug abuse violations</u>	0	0	1
c. <u>Liquor law violations</u>	3	3	0

**Caveat:**

If you have changed prior years' data, you must add a caveat explaining the change. Use the following format: "For (YEAR), Line (X) was changed from (A) to (B) because (REASON)."



Institution: Seminole State College (207740) -  
Seminole State College (001)

User ID: C12077401

## Disciplinary Actions - Noncampus

Enter the number of persons referred for disciplinary action for crimes that occurred in or on Noncampus buildings or property for each of the following categories.

Do not include disciplinary actions that were strictly for school policy violations.

If the disciplinary action is the result of an arrest, please do not count it here; count the violation as 1 arrest.

Do NOT include drunkenness or driving under the influence in Liquor law violations.

Crime	Number of persons referred for Disciplinary Action		
	2008	2009	2010
a. <u>Weapons: carrying, possessing, etc.</u>	0	<input type="text" value="0"/>	<input type="text" value="0"/>
b. <u>Drug abuse violations</u>	0	<input type="text" value="0"/>	<input type="text" value="0"/>
c. <u>Liquor law violations</u>	3	<input type="text" value="0"/>	<input type="text" value="0"/>

**Caveat:**

If you have changed prior years' data, you must add a caveat explaining the change. Use the following format: "For (YEAR), Line (X) was changed from (A) to (B) because (REASON)."



## Disciplinary Actions - Public Property

**Enter the number of persons referred for disciplinary action for crimes that occurred on Public Property for each of the following categories. Do not include disciplinary actions that were strictly for school policy violations. If the disciplinary action is the result of an arrest, please do not count it here; count the violation as 1 arrest.**

**Do NOT include drunkenness or driving under the influence in Liquor law violations.**

Crime	Number of persons referred for Disciplinary Action		
	2008	2009	2010
a. <u>Weapons: carrying, possessing, etc.</u>	0	<input type="text" value="0"/>	<input type="text" value="0"/>
b. <u>Drug abuse violations</u>	0	<input type="text" value="1"/>	<input type="text" value="0"/>
c. <u>Liquor law violations</u>	0	<input type="text" value="4"/>	<input type="text" value="0"/>

**Caveat:**

If you have changed prior years' data, you must add a caveat explaining the change. Use the following format: "For (YEAR), Line (X) was changed from (A) to (B) because (REASON)."

A rectangular box with a border, containing a vertical line on the left side and a horizontal line at the bottom. On the right side, there are two small triangles pointing up and down, and a small square at the bottom right corner.